



4 The Old Bakery, 20 Bedford Road, Barton-Le-Clay, Bedfordshire,
MK45 4JU

5370

- Exclusive to PR Property
- Well presented throughout
- Allocated parking space
- To let: one bedroom flat
- Close to shops and local amenities
- Communal garden area
- First floor position
- Village location
- Available now

**** Exclusive to PR Property **** A well presented first floor one bedroom flat in a popular village location, ideally placed for everyday convenience with shops and local amenities close by. The property offers comfortable, low maintenance living and would suit a single professional or couple looking for an easy move. Outside, there is an allocated parking space plus the benefit of a communal garden area for residents to enjoy. Available now.

ENTRANCE HALL

LIVING ROOM 11'5" X 13'1" (3.48M X 3.99M)

KITCHEN 4'8" X 7'4" (1.41M X 2.24M)

BEDROOM 1 6'6" X 10'11" (1.99M X 3.32M)

SHOWER ROOM

First Floor

Approx. 28.9 sq. metres (310.9 sq. feet)

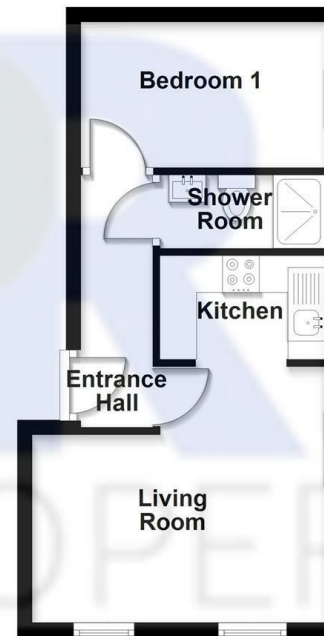

Total area: approx. 28.9 sq. metres (310.9 sq. feet)

4 The Old Bakery, Barton Le Clay

Energy Efficiency Rating		
	Current	Potential
Very energy efficient - lower running costs		
(92 plus) A		
(81-91) B		
(69-80) C		
(55-68) D	67	76
(39-54) E		
(21-38) F		
(1-20) G		
Not energy efficient - higher running costs		
England & Wales		
EU Directive 2002/91/EC		